

MASTER SITE PLAN

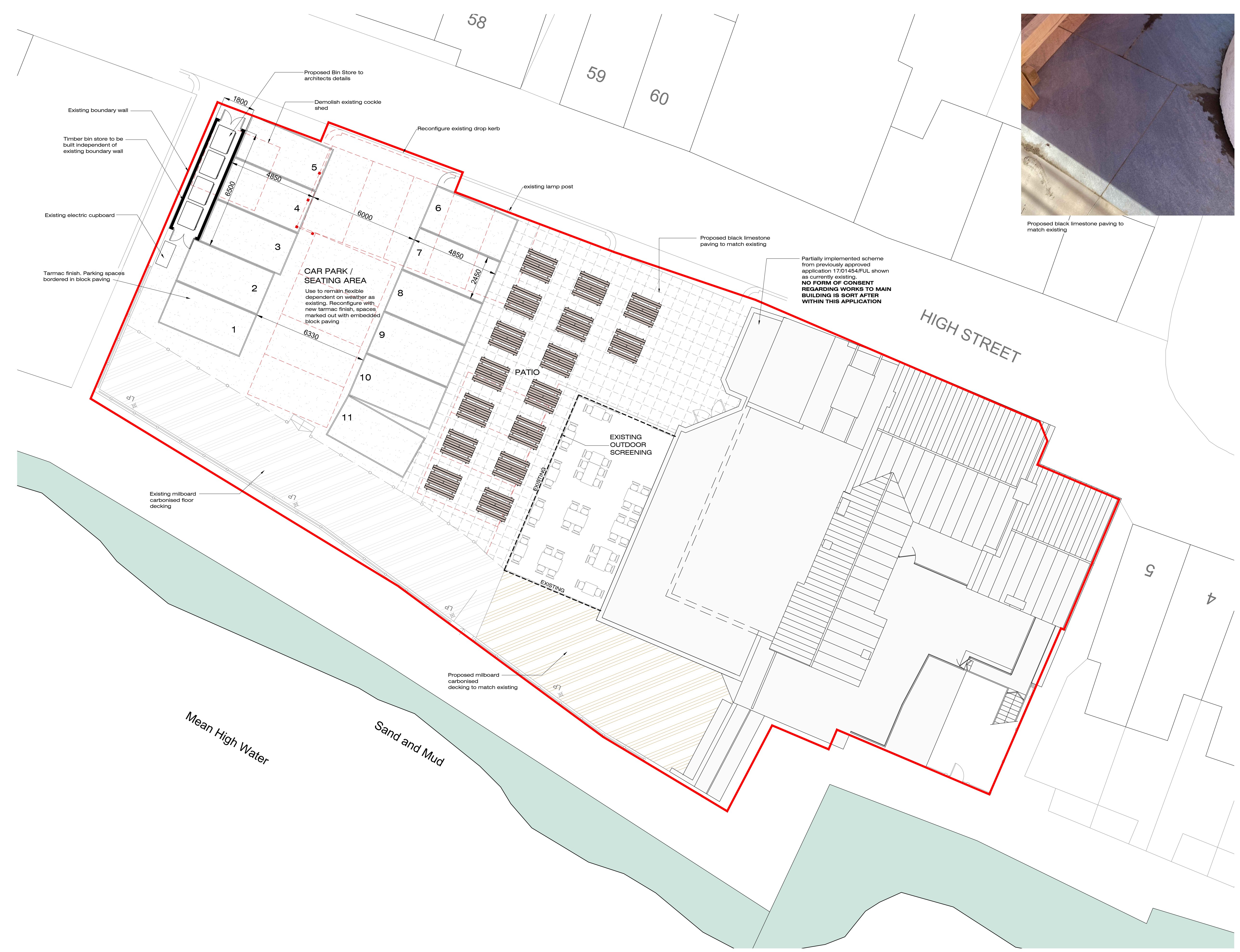

Proposed black limestone paving to match existing

The contractor is to check and verify all building and site dimensions, levels, and sewer invert levels at connection points before work starts.
This drawing must be read with and checked against any structural or other specialist drawings provided.
The contractor is to comply in all respects with the current Building Regulations whether or not specifically stated on these drawings.
This drawing is not intended to show details of foundations or ground conditions. Each area of ground relied upon to support the structure depicted must be investigated by the contractor and suitable methods of foundations provided.
This drawing is to be read in conjunction with all other standard STONE ME! DESIGN LTD specifications and documentation
This drawing remains the copyright of STONE ME! DESIGN LTD and cannot be reproduced without prior permission.
STONE ME! DESIGN LTD reserves the right to withdraw any drawings from any applications or third parties should disputes arise between the client and STONE ME! DESIGN LTD

REV:	DATE:	AMENDMENT:
STONE Me! ARCHITECTURE & INTERIOR DESIGN		
5 FOUNTAIN LANE, HOCKLEY, ESSEX, SS5 4ST Tel: 01702 203333 E: info@stoneme.com W: www.stoneme.com		
Client:	EAST ANGLIA PUB CO.	
Project:	THE PETER BOAT 27 HIGH STREET, LEIGH-ON-SEA, ESSEX, SS9 2EN	
Drawing:	PROPOSED MASTER SITE PLAN	
Date:	APR 2022	Scale: 1:100 @ A1
Project No.:	1266	Drawing No.: 2052e